



## Holistic Design

Seamless Wall and  
Floor Solutions



## Contents

- 03 \_ Master Builders Solutions
- 04 \_ Expertise from floor to walls
- 06 \_ Seamless transitions for boundless designs
- 08 \_ All-round solutions for your success
- 10 \_ Immune to rough treatment
- 12 \_ Hygiene from floor to ceiling





# Master Builders Solutions

The Master Builders Solutions brand brings all of our expertise together to create chemical solutions for new construction, maintenance, repair and renovation of structures. Master Builders Solutions is built on the experience gained from more than a century in the construction industry. The know-how and experience of a global community of construction experts form the core of Master Builders Solutions.

We combine the right elements from our portfolio to solve your specific construction challenges. We collaborate across areas of expertise and regions and draw on the experience gained from countless construction projects worldwide. We leverage global technologies, as well as our in-depth knowledge of local building needs, to develop innovations that help make you more successful and drive sustainable construction.

The comprehensive portfolio under the Master Builders Solutions brand encompasses concrete admixtures, cement additives, solutions for underground construction, waterproofing solutions, sealants, concrete repair & protection solutions, performance grouts, performance flooring solutions and solutions for on- and offshore wind energy.

## Our comprehensive portfolio

- Concrete admixtures
- Cement additives
- Chemical solutions for underground construction
- Waterproofing solutions
- Sealants
- Concrete repair and protection solutions
- Performance grouts
- Wind turbine grouts
- Performance flooring solutions



## Expertise from Floor to Walls

**Designing with surfaces.** Uniform materials from floor to walls: we at Master Builders Solutions offer you tailor-made solutions for seamless, holistic interior designs for whichever project you have in mind.

**For big plans, you need a strong partner.**

We at Master Builders Solutions can look back on more than one hundred years of experience in the construction chemicals field. Thanks to this experience and continuous investment in research and development, we are in a position to develop optimum product solutions.

**As a specialist in seamless flooring systems,**

we offer tailor-made solutions for any application. Our flooring systems are not only perfectly suited to meet functional requirements, but also allow interior designers considerable leeway for creativity, and have convincing installation properties.

**We have now expanded this potential:**

Wall systems from Master Builders Solutions provide a seamless connection to our tried and tested floor coverings, allowing walls and floors to be designed as a functional and aesthetic unit.







Our reference in Altshausen (Germany):  
Leopoldschule





Our reference in Baar-Inwil (Switzerland):  
Zuwebe (formerly Canton of Zug workshop for the disabled)  
© Ottiger Fotografie Zug/HTS Architekten, Cham

## Your benefits at a glance

### Individual:

- No limits to wall designs
- Wide range of colors

### Excellent environmental performance:

- Low emissions in accordance with international and European standards
- Non-solvent wall systems for sustainable construction
- Based on renewable raw materials



# Seamless Transitions for Boundless Designs

Walls and floors that are “all of a piece” – a design element which plays an increasingly important role in contemporary architecture.

Single-color design using light tones creates a calm appearance, while vibrant colors make functional rooms more vivid. Spaces may be designed individually or even artistically.

Creative use of colors allows smooth transitions, provides orientation and offers almost boundless design possibilities. The result is a holistic approach to your interior design, with design and function ideally adapted to individual requirements.



“A holistic approach to interior design allows bold designs that provide orientation and create a sense of well-being – without any spatial, material or optical barriers.”

Heinz Merz, President of zuwebe  
The walls and floors at zuwebe (formerly Canton of Zug Workshop for the Disabled) were coated with flooring products from Master Builders Solutions without barriers or joints, in line with a specially developed color scheme.

## Reliable and versatile:

- Liquid application of all system components, without joints or seams
- Easy use in rooms with complex shapes

## Economical:

- Short installation times for rapid construction progress
- Tough, wear-resistant surfaces with a long service life
- Positive environmental balance
- Easy-to-clean surface for low maintenance expenses
- Low life-cycle costs



# All-Round Solutions for Your Success

The architecture, interior design and color scheme of a company's premises are its business card, and give visible expression to a company's values and its corporate identity. Continuous surfaces create an impression of spaciousness and elegance. The design of the reception area is especially important. It creates a first impression with visitors and must provide orientation as well as impressing them with an elegant appearance.

For decorative applications, the MasterTop WS 100 PU universal wall covering system is your solution of choice, offering almost unlimited design possibilities for your project. The wide variety of shapes and colors allows ideal alignment with the floor for a holistic room design. The system consists of only two layers (primer and top coat) and can therefore also be used in existing buildings, for example in refurbishment projects.

## System example MasterTop WS 100 PU\*

For holistic room designs with seamless surfaces.

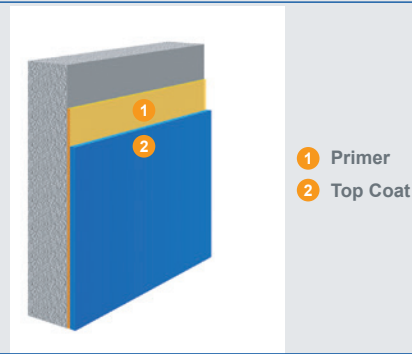

### System features

- Smooth, matt surface
- Low emissions
- Resists ultraviolet light

### System benefits

- Low maintenance expenses thanks to easy cleaning of seamless surface
- Individual design
- Low to moderate impact strength
- Resists bacterial growth and chemical stresses (MasterTop WS 100 AB)
- Perfect harmony between appearance of floor and walls

### Other applications

reception areas, atria, hallways, production halls, storage areas, technical rooms, offices, apartments, etc.

Variant MasterTop WS 100 AB:  
hospitals, residential homes, etc.

\*The appropriate wall system must be selected based on the requirements of the individual project.





Our reference in Toulouse (France):  
Ophthalmology Centre of Nouvelle Clinique de l'Union





Our reference in Winterthur (Switzerland):  
Lindberg Private Clinic





# Immune to Rough Treatment

Wherever hospital beds knock walls, guests' suitcases hit corners or goods are manufactured and stored every day, high resilience and impact strength are essential.

Our MasterTop WS 200 PU is the right wall system to use wherever walls need to be both decorative and strong. In addition to a wide variety of design possibilities, its thick elastic coating system also offers high impact strength and reliable crack-bridging properties.

MasterTop WS 200 PU can be sealed using a pore-free anti-bacterial top coat, offering extraordinarily high resistance to bacteria, chemicals, discoloration and abrasion. In combination with MasterTop AB floor coverings, this wall system ensures a seamless protective envelope, ideal for healthcare facilities.

## System example MasterTop WS 200 PU\*

Functional elastic wall systems for decorative applications.

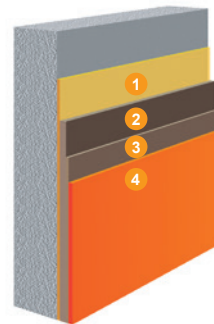

- 1 Primer
- 2 Body Coat (first layer)
- 3 Body Coat (second layer)
- 4 Top Coat

### System features

- Low emissions
- Elastic
- High impact strength
- Waterproof
- Resistant to ultraviolet light
- Soft feel effect

### System benefits

- Smooth, matt surface
- Individual design
- Antibacterial variant resists bacterial growth, chemical attack, discoloration and abrasion
- Perfect harmony between appearance of floor and walls

### Other applications

corridors, hotels, healthcare facilities, production halls, storage areas

\*The appropriate wall system must be selected based on the requirements of the individual project.



# Hygiene from Floor to Ceiling

The transition between floor and walls is extremely important, particularly in bathrooms and other wet rooms, as this is where moisture collects. Among the many requirements for such rooms are continuous design and long-term waterproofing, preferably without joints or corners. A seamless surface has decisive advantages for hygiene and well-being over conventional wall coverings such as tiles. Our MasterTop WS 300 PU is an especially high-strength hygienic system that meets the most stringent user health requirements. The system is waterproof and easy to clean, as well as preventing mould formation which could present a health risk.

With MasterTop WS 300 PU, you will have a whole range of new possibilities. A reinforcing mesh is integrated within the wall covering, ensuring that it can resist the most arduous conditions caused by moisture and temperature changes. After all, surfaces in bathrooms and other wet rooms have a tendency to warp. In industrial and other highly stressed areas, this wall system ensures high levels of impact strength. The matt, ultraviolet-resistant surface allows individual designs, which are especially interesting for use in private bathrooms.

## System example Mastertop WS 300 PU\*

Functional elastic wall systems for decorative applications.

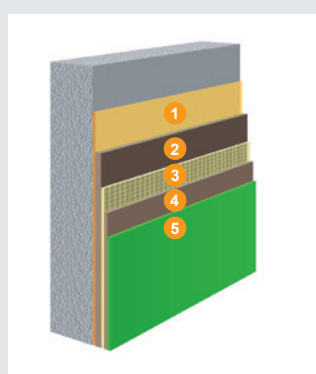

- 1 Primer
- 2 Body Coat
- 3 Reinforcing Mesh
- 4 Mesh Sealant
- 5 Top Coat

### System features

- Low emissions
- Elastic
- High impact strength
- Waterproof
- Resistant to ultraviolet light
- Soft feel effect

### System benefits

- Very high impact strength and stability thanks to reinforcing mesh
- Low maintenance expenses thanks to easy cleaning of seamless surfaces
- Individual design
- Ideal for renovation work on various surfaces
- Antibacterial variant resists bacterial growth, chemical attack, discoloration and abrasion
- Perfect harmony between the appearance of floor and walls

### Other applications

production halls, storage areas, corridors, technical rooms, bathrooms, hotels, healthcare facilities

\*The appropriate flooring system must be selected on the basis of the particular requirements for the individual project.





Our reference in Altshausen (Germany):  
Leopoldschule



Our reference in Zurich (Switzerland):  
ETH Sports Center





## Notes

[illegible]



# Master Builders Solutions for the Construction Industry

## **MasterAir**

Complete solutions for air entrained concrete

## **MasterBrace**

Solutions for concrete strengthening

## **MasterCast**

Solutions for the manufactured concrete product industry

## **MasterCem**

Solutions for cement manufacture

## **MasterEase**

Low viscosity for high performance concrete

## **MasterEmaco**

Solutions for concrete repair

## **MasterFinish**

Solutions for formwork treatment and surface improvement

## **MasterFlow**

Solutions for precision grouting

## **MasterFiber**

Comprehensive solutions for fiber reinforced concrete

## **MasterGlenium**

Solutions for high performance concrete

## **MasterInject**

Solutions for concrete injection

## **MasterKure**

Solutions for concrete curing

## **MasterLife**

Solutions for enhanced durability

## **MasterMatrix**

Advanced rheology control for concrete

## **MasterPel**

Solutions for hydrophobization, anti-efflorescence and surface protection

## **MasterPolyheed**

Solutions for mid-range concrete

## **MasterPozzolith**

Solutions for water-reduced concrete

## **MasterProtect**

Solutions for concrete protection

## **MasterRheobuild**

Solutions for high strength concrete

## **MasterRoc**

Solutions for underground construction

## **MasterSeal**

Solutions for waterproofing and sealing

## **MasterSet**

Solutions for set control

## **MasterSphere**

Solutions for guaranteed freeze-thaw resistance

## **MasterSuna**

Solutions for sand and gravel in concrete

## **MasterSure**

Solutions for extraordinary workability retention

## **MasterTop**

Solutions for industrial and commercial floors

## **Master X-Seed**

Advanced accelerator solutions for concrete

## **Ucrete**

Flooring solutions for harsh environments



## QUANTIFIED SUSTAINABLE BENEFITS ADVANCED CHEMISTRY BY MASTER BUILDERS SOLUTIONS

**Let the numbers do the talking:** We have portrayed some of our most eco-efficient product solutions for concrete and precast production, construction, civil engineering, and flooring.

[sustainability.master-builders-solutions.com](https://sustainability.master-builders-solutions.com)



### **Master Builders Solutions UK Ltd**

19 Broad Ground Road, Lakeside, Redditch  
Worcestershire, B98 8YP, United Kingdom  
P +44 1527 512 255, F +44 1527 503 576  
[reditchcom@mbcc-group.com](mailto:reditchcom@mbcc-group.com)  
[www.master-builders-solutions.com](http://www.master-builders-solutions.com)

### **Master Builders Solutions UK Ltd**

Swinton Hall Road, Swinton  
Manchester, M27 4EU, United Kingdom  
P +44 161 727 6300  
[cheadle-csd@mbcc-group.com](mailto:cheadle-csd@mbcc-group.com)  
[www.master-builders-solutions.com](http://www.master-builders-solutions.com)

The data contained in this publication are based on our current knowledge and experience. They do not constitute the agreed contractual quality of the product and, in view of the many factors that may affect processing and application of our products, do not relieve processors from carrying out their own investigations and tests. The agreed contractual quality of the product at the time of transfer of risk is based solely on the data in the specification data sheet. Any descriptions, drawings, photographs, data, proportions, weights, etc. given in this publication may change without prior information. It is the responsibility of the recipient of our product to ensure that any proprietary rights and existing laws and legislation are observed (01/2021).

® = registered trademark of MBCC Group companies in many countries

MBS-01-2021-PF-0030-EN